

# *meta***FLEX**<sup>PRO</sup>



**High-  
Performance  
Family of  
FIRE  
BARRIERS  
for Large  
Expansion  
Joints**

- Simplified installation, intuitive splicing
- Movement up to 72" max open
- Tested and listed in accordance with UL 2079 and ASTM E1966



# metaFLEX<sup>PRO</sup>

## Family of FIRE BARRIERS

Introducing the industry's highest-performing fire barriers for large expansion joints. This new and improved family of products simplify the installation process, significantly reducing the installation time. With quality features and unique additions, these are ideal products for fire-rated seismic joints, surpassing fire resistance and movement testing requirements of test standards UL 2079 and ASTM E1966.

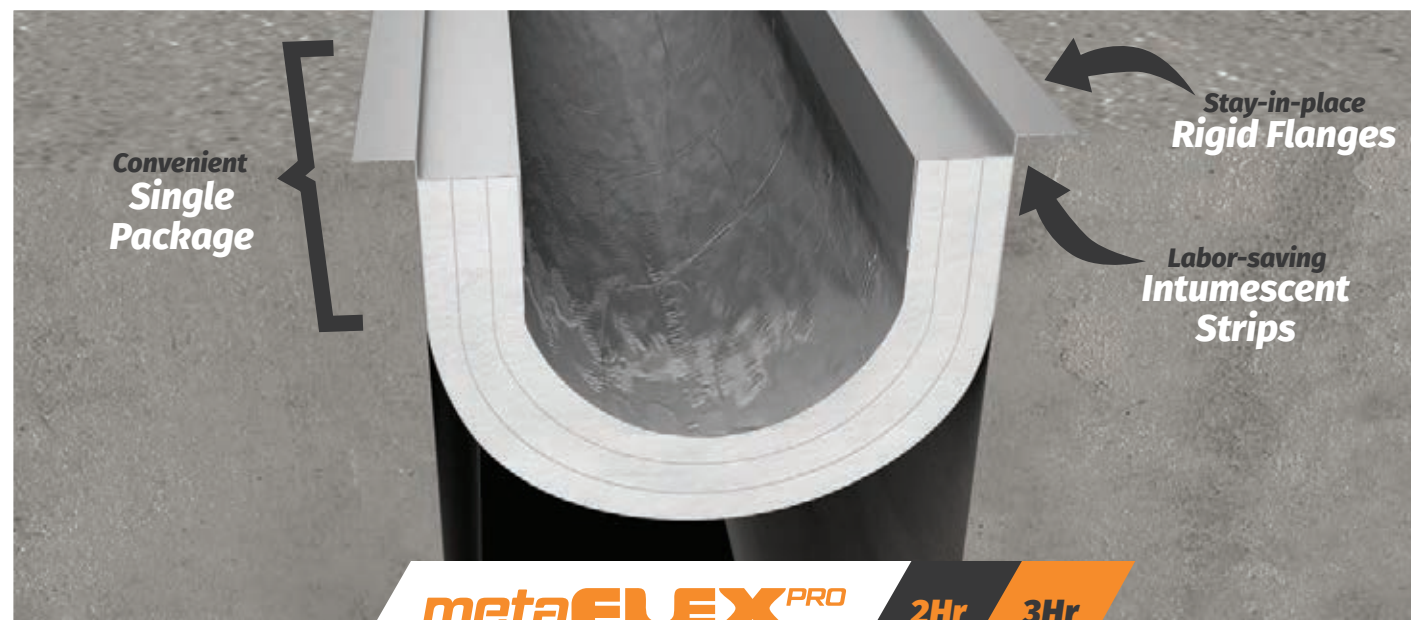

- Bold single package with rigid side flanges serving to hold the fire barrier rigidly in place for a convenient drop-in installation; Inside Mount variation available for applications requiring no surface contact
- Sides are lined with Metacaulk's BlazeSeal™ intumescent strips, entirely eliminating the need for laborious caulking of firestop sealant along the sides of the joint
- Comes standard with male/female ends for easy and intuitive lap splicing
- Available up to 36" max open at ±100-percent movement\*

\*36" max open does not apply to 3-hour MetaFlex Pro (MPF3H).

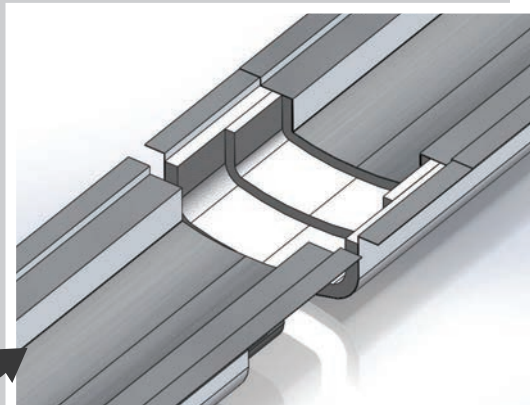

balcousa.com



1.800.767.0082

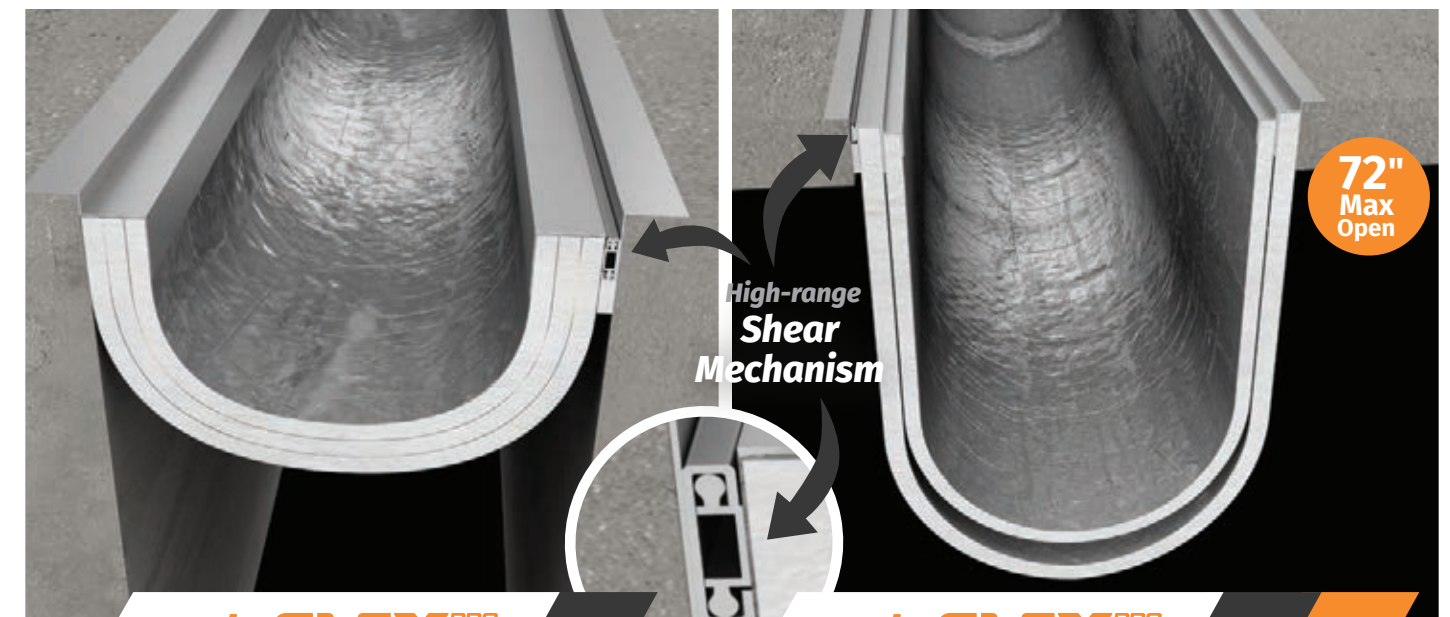

- Same great features and performance of the MetaFlex Pro with the addition of a mechanized flange along one side allowing for up to ±100-percent horizontal shear movement; designed for applications requiring lateral shear. MetaFlex Pro Shear MAX extends the MetaFlex Pro Shear design to 72" max open with ±100-percent multi-directional movement; ideal for locations of high seismic activity

- The MetaFlex Pro Shear and Shear MAX are available for wall conditions with the same 72" max open and ±100-percent multi-directional movement (seismic activity); fire protected from both directions



- A version of the MetaFlex Pro mounted beneath the floor slab rather than from above, ideal for retrofit applications, conditions with existing expansion joint covers, in-joint obstructions or chase walls preventing access from above



balcousa.com



1.800.767.0082



APPLICATION

- Fire-resistant barrier for horizontal expansion joints (up to 36" max open\*)

FEATURES

- Easy “drop-in” installation; no firestop sealant required
- Simple lap splicing
- Ships in 10' (3m) lengths
- Doubles as smoke barrier
- Can be integrated with Balco Expansion Joint Systems
- Inside Mount variation (installed within joint without surface contact) available

PERFORMANCE

- Fire resistance rating of 2 hours and 3 hours tested in accordance with ASTM E1966 and UL 2079
- Intumescent BlazeSeal™ seal beneath flanges is tested in accordance with UL 1479
- Seismic, Thermal and Wind movement tested per standard ASTM E1399



- Contributes to LEED® credits

JOINT SIZES (nominal)

6-24" (150-600mm)\*

MOVEMENT

±50% to ±100% Expansion/Contr.



Vertical Shear Varies



MPF2H 2 Hour

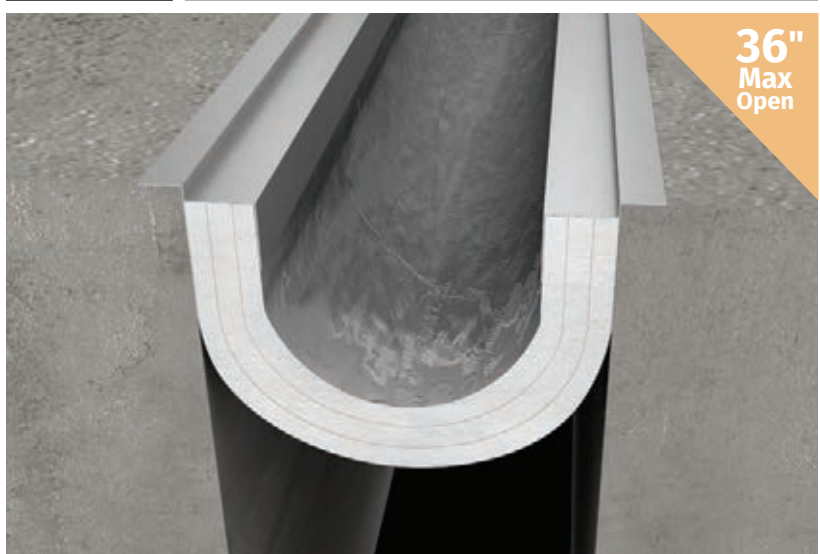

MPF3H 3 Hour

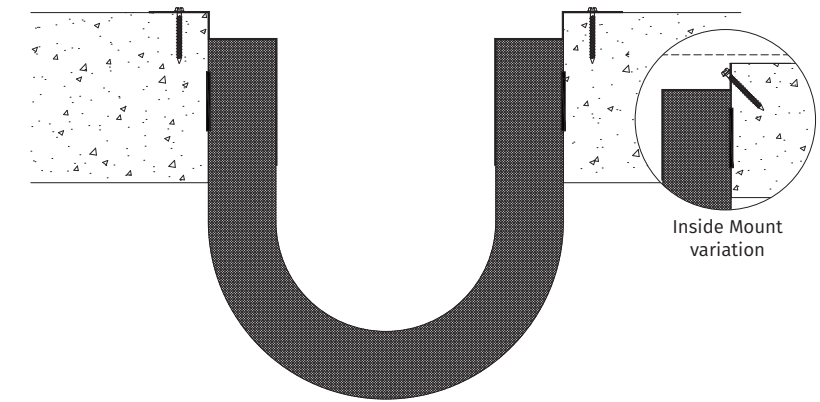

\*36" max open does not apply to 3-hour MetaFlex Pro (MPF3H).

APPLICATION

- Fire-resistant barrier for horizontal expansion joints (up to 36" max open)

FEATURES

- Easy “drop-in” installation; no firestop sealant required
- Simple lap splicing
- Slide mechanism permits horizontal shearing
- Ships in 10' (3m) lengths
- Doubles as smoke barrier
- Can be integrated with Balco Expansion Joint Systems

PERFORMANCE

- Fire resistance rating of 2 hours tested in accordance with ASTM E1966 and UL 2079
- Intumescent BlazeSeal™ seal beneath flanges is tested in accordance with UL 1479
- Seismic, Thermal and Wind movement tested per standard ASTM E1399



- Contributes to LEED® credits

JOINT SIZES (nominal)

6-24" (150-600mm)\*

MOVEMENT

±50% to ±100% Expansion/Contr.



±100% Lateral Shear



Vertical Shear Varies



MPSF2H 2 Hour

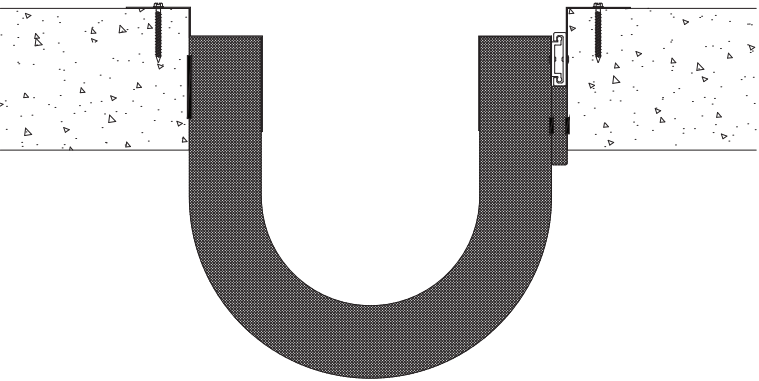
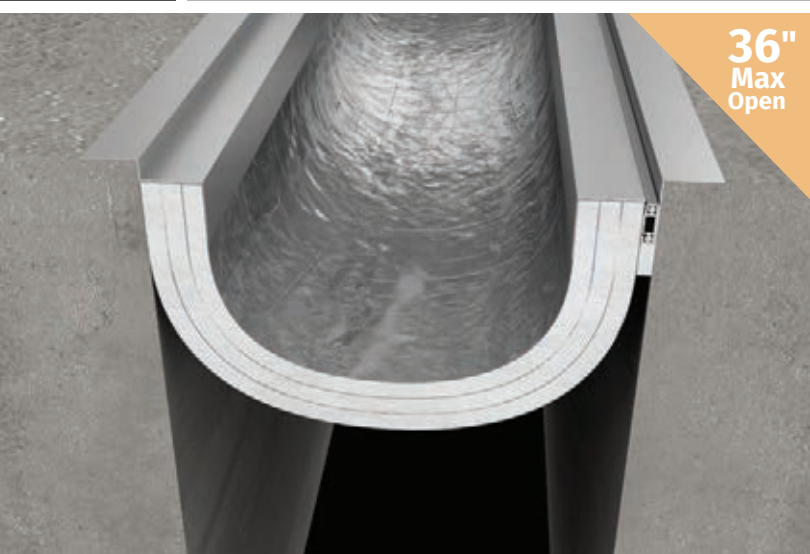

\*See MetaFlex Pro Shear Max for larger sizes.

metaFLEX<sup>PRO</sup>  
S H E A R M A X

APPLICATION

- Fire-resistant barrier for horizontal expansion joints (up to 72" max open)

FEATURES

- Convenient two-package installation
- Simple lap splicing
- Slide mechanism permits horizontal shearing
- Ships in 4' (1.2m) lengths
- Doubles as smoke barrier
- Can be integrated with Balco Expansion Joint Systems

PERFORMANCE

- Fire resistance rating of 2 hours and 3 hours tested in accordance with ASTM E1966 and UL 2079
- Air leakage (L rating in SCFM/LF) of 3.88 ambient & 4.16 heated per UL 2079; meets IBC 715.6 requirements for smoke barriers
- Intumescent BlazeSeal™ seal beneath flanges is tested in accordance with UL 1479
- Seismic, Thermal and Wind movement tested per standard ASTM E1399



- Contributes to LEED® credits

JOINT SIZES (nominal)

25-48" (635-1200mm)

MOVEMENT

±50% to ±100% Expansion/Contr.



±100% Lateral Shear



±100% Vertical Shear



MPSF2H

2 Hour

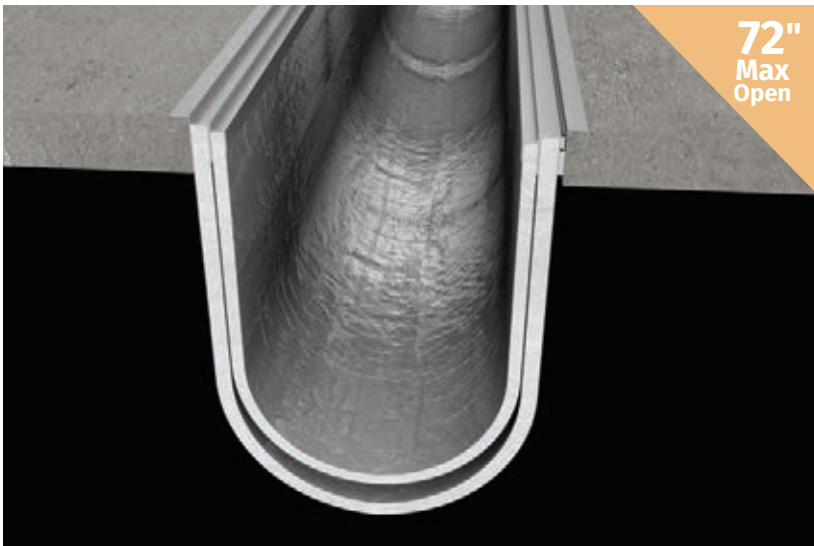

72"  
Max  
Open

MPSF3H

3 Hour

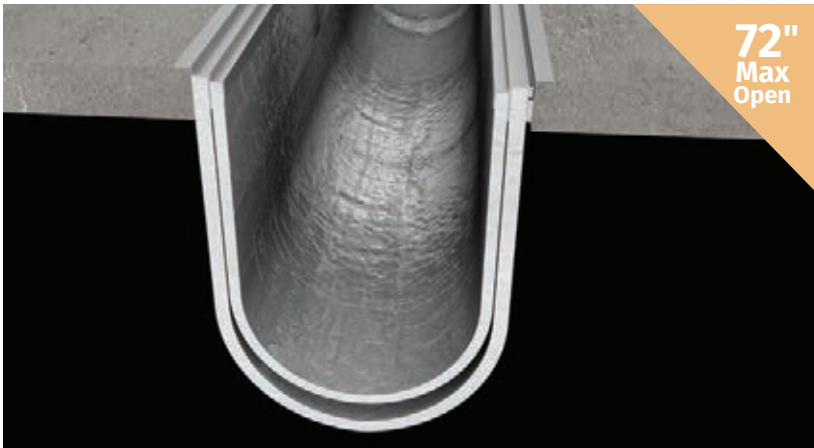

72"  
Max  
Open



\*See MetaFlex Pro Shear for smaller sizes.

metaFLEX<sup>PRO</sup>  
UNDERMOUNT

APPLICATION

- Fire-resistant barrier for horizontal expansion joints (up to 36" max open)

FEATURES

- Mounts to underside of floor slabs when access from above is limited
- Simple lap splicing
- Ships in 5' (1.5m) lengths
- Doubles as smoke barrier
- Can be integrated with Balco Expansion Joint Systems

PERFORMANCE

- Fire resistance rating of 2 hours tested in accordance with ASTM E1966 and UL 2079
- Intumescent BlazeSeal™ seal beneath flanges is tested in accordance with UL 1479
- Seismic, Thermal and Wind movement tested per standard ASTM E1399



- Contributes to LEED® credits

JOINT SIZES (nominal)

6-24" (150-450mm)

MOVEMENT

±50% to ±100% Expansion/Contr.

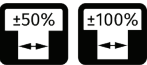

MPUF2H

2 Hour

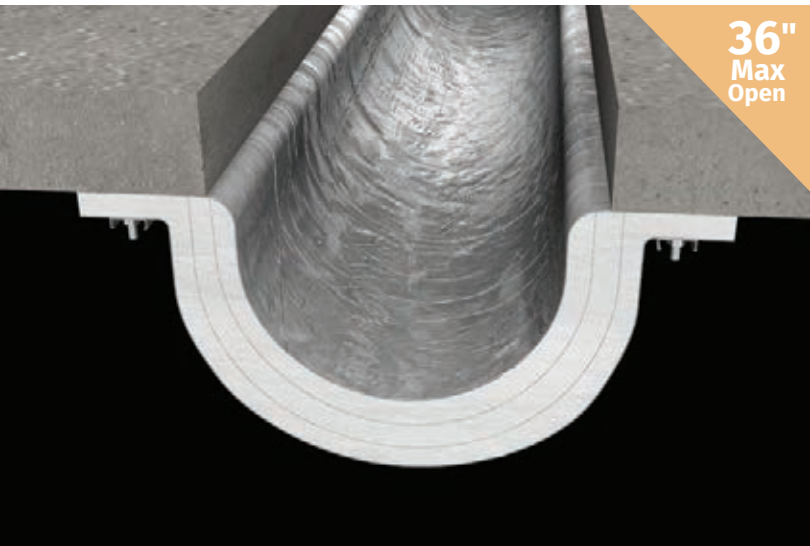

36"  
Max  
Open

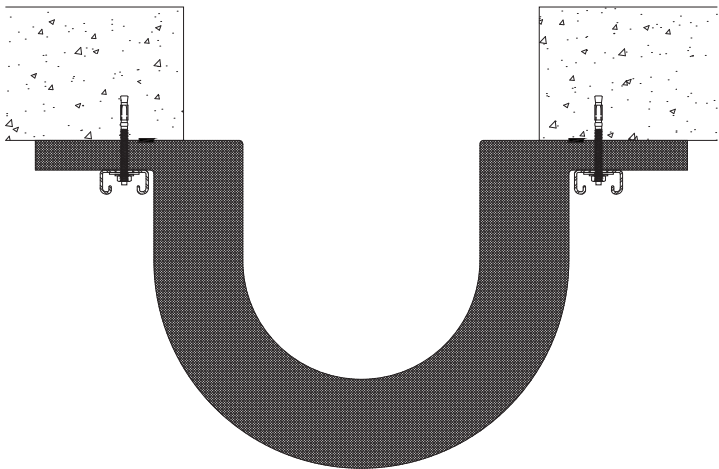



APPLICATION

- Fire-resistant barrier for vertical expansion joints (up to 18" max open)

FEATURES

- Convenient single-package installation
- Fire protection from both directions
- Intuitive lap splicing
- Ships in 10' (3m) lengths
- Doubles as smoke barrier
- Can be integrated with Balco Expansion Joint Systems

PERFORMANCE

- Fire resistance rating of 2 hours tested in accordance with ASTM E1966 and UL 2079
- Air leakage (L rating) <5 SCFM/LF per UL 2079; meets IBC 715.6 requirements for smoke barriers
- Intumescent BlazeSeal™ seal beneath flanges is tested in accordance with UL 1479
- Seismic, Thermal and Wind movement tested per standard ASTM E1399



- Contributes to LEED® credits

JOINT SIZES (nominal)

4-12" (100-300mm)

MOVEMENT

±50% to ±100% Expansion/Contr.



Lateral Shear Varies



Vertical Shear Varies



MPSW2H

2 Hour

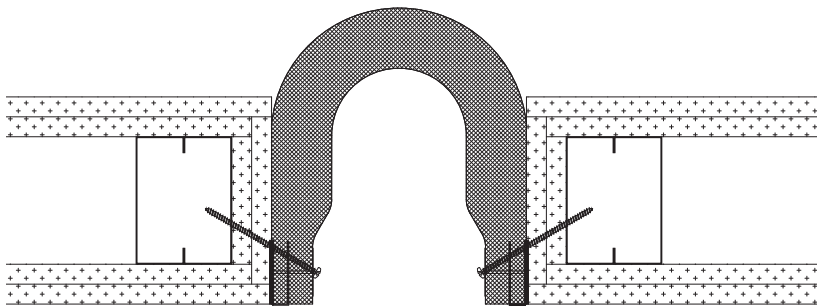
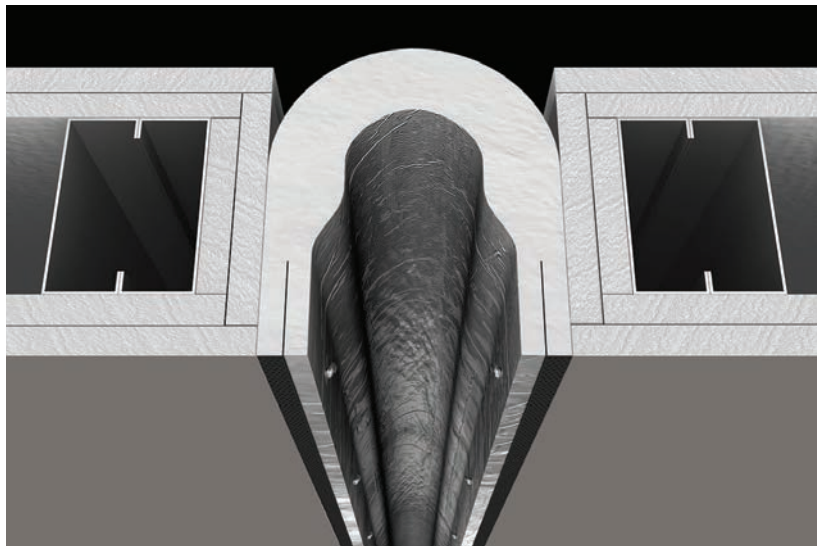

APPLICATION

- Fire-resistant barrier for larger vertical expansion joints (up to 72" max open)

FEATURES

- Convenient two-package installation
- Fire protection from both directions
- Ships in 4' (1.2m) lengths
- Doubles as smoke barrier
- Can be integrated with Balco Expansion Joint Systems

PERFORMANCE

- Fire resistance rating of 2 hours tested in accordance with ASTM E1966 and UL 2079
- Air leakage (L rating in SCFM/LF) of 3.88 ambient & 4.16 heated per UL 2079; meets IBC 715.6 requirements for smoke barriers
- Intumescent BlazeSeal™ seal beneath flanges is tested in accordance with UL 1479
- Seismic, Thermal and Wind movement tested per standard ASTM E1399



- Contributes to LEED® credits

JOINT SIZES (nominal)

20-48" (500-1200mm)

MOVEMENT

±50% to ±100% Expansion/Contr.

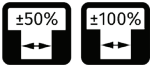

Lateral Shear Varies



Vertical Shear Varies



MPSW2H

2 Hour

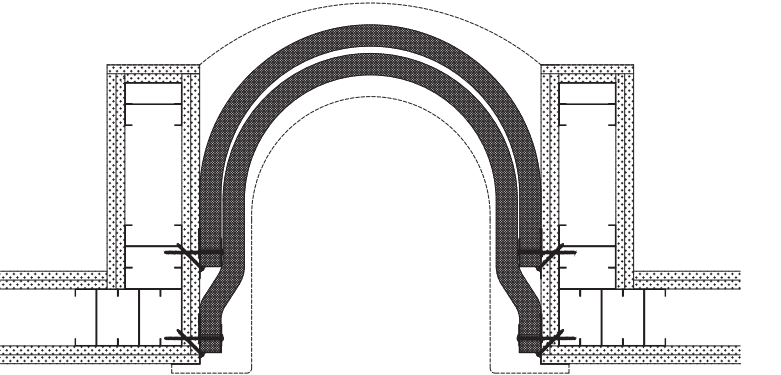



**MetaFlex® Pro - 2Hr**

**MetaFlex® Pro - 3Hr**

**MetaFlex® Pro Shear - Floor - 2Hr**

**MetaFlex® Pro Shear MAX - Floor - 2Hr & 3Hr**

**MetaFlex® Pro Shear - Wall - 2Hr**

**MetaFlex® Pro Shear MAX - Wall - 2Hr**

**MetaFlex® Pro Undermount - 2Hr**

**Other Fire Barriers:**

**MetaBlock® | MetaMat™ | BCS Foam**



A CSW Industrials Company

**CERTIFIED ISO 9001**  
Quality Management System



Balco®, Inc. 2626 S Sheridan, PO Box 17249, Wichita, Kansas 67217 Phone 316.945.9328 800.767.0082 [balcousa.com](http://balcousa.com)  
Balco, the logos and other trademarks are property of Balco, Inc., its affiliates or its licensors and are protected by copyright, trademark and other intellectual property laws, and may not be used without permission. Balco, Inc. reserves the right to change specifications without prior notice.  
© 2012-2020 Balco, Inc. All rights reserved. B50086-1220