



ReSound GN

## Quick guide

ReSound ENZO 3D™ 98

**GN** Making Life Sound Better

# My hearing aid information

**Product:** ReSound ENZO 3D™

**Model:** 98

**Serial number (R):**

---

**Serial number (L):**

---

**Battery size:** 675

## Program button (A):

ACTION	RESULT
SHORT push	Program change
LONG push	Activate streaming (if enabled by professional)

## Volume control (C):

ACTION	RESULT
Press UP	Volume increases
Press DOWN	Volume decreases
Long Press DOWN	Minimum volume OR Stand-by mode (if enabled by professional)

## Programs:

(if set up by your hearing care professional)

PROGRAM	WHEN TO USE	BEEPS
1		1
2		2
3		3
4		4

## Get to know your hearing aid

A. Program button

B. Microphones

C. Volume control

D. Battery door

E. Right/Left indicator

F. Groove for DAI/FM boot

G. Earhook

H. Earmold and tubing

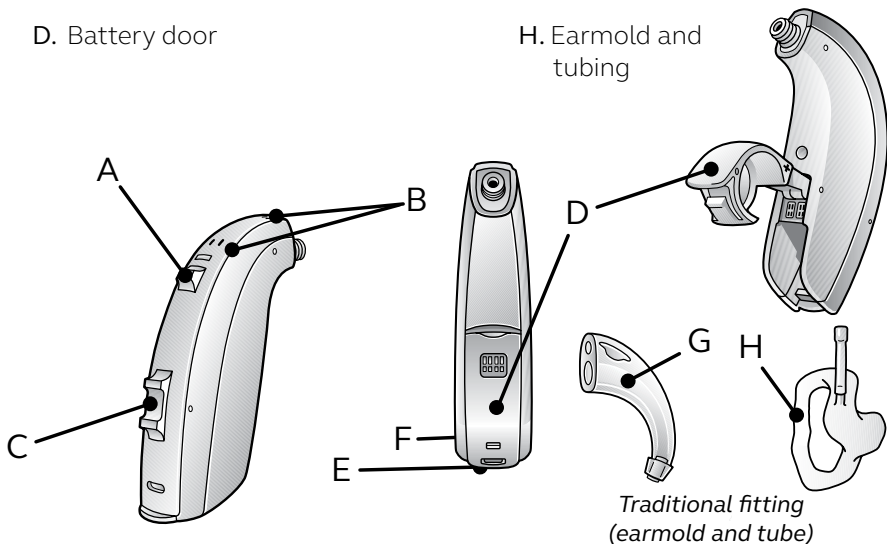

View ReSound's hearing aid tutorial videos at [youtube.com/resoundus](https://youtube.com/resoundus).

## What you need to know

**Getting Started:** On/Off function

**ON:** Insert battery & completely close battery door (D).  
Program 1 will be active.

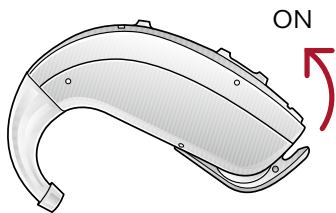

**OFF:** Open the battery door (D). Use fingertip to pull it all the way.

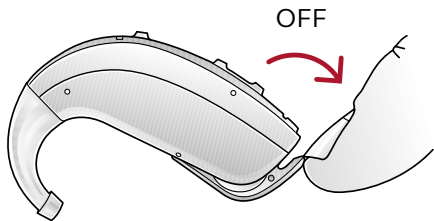

## Inserting/Replacing the battery:

1. Open the battery door (D) completely by using your fingertip.

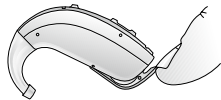

2. Remove protective sticker from battery and wait 2 minutes before inserting the battery into the hearing aid to allow full activation of the battery.



3. Insert the new battery with the positive side (flat side) in the correct position, as shown.

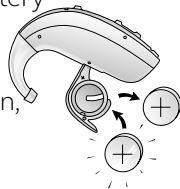

4. Gently close the battery door. If it doesn't close easily, check to see if the battery is upside down.

## Flight mode:

Some airlines prohibit the use of wireless hearing aids (RF transmitters) onboard. If required by your airline, enable flight mode:

**Disable wireless operation** by opening and closing the battery door (D) three times within ten seconds (open-close, open-close, open-close). Your instruments will now be in flight mode.

The hearing aids must function in flight mode for 10 seconds before wireless operation can be re-enabled.

**To re-enable wireless operation**, open and close the battery door one time and wait thirty seconds before opening the battery door again to avoid accidentally entering flight mode again.

## Regular care & maintenance

**Daily:** Clean your hearing aid.

Keep your hearing aids dry. Clean the hearing aids using a soft cloth or tissue.

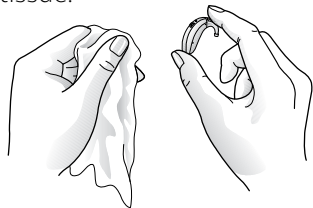

**Weekly:** Clean tubes and earmold (H).

1. Remove earmolds and tubing from hearing aid prior to cleaning.
2. Clean earmold using mild soap, remove any residual.
3. After cleaning, dry earmolds thoroughly, remove any residual water and debris from the tubing utilizing an air bulb and wire loop.

## Connecting/disconnecting direct audio boot or Integrated FM

### Connecting audio boot and integrated FM

1. Align the tip of the audio boot or integrated FM boot with designated groove (F).
2. Once in place, move the boot in the direction of the battery compartment.
3. Gently click the boot onto the hearing instrument.



Direct Audio



Integrated FM

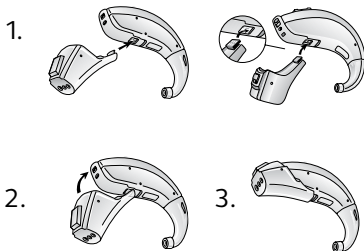

### Disconnecting audio boot and integrated FM

1. Press and hold the button on the front side of the audio boot. For an FM boot, slide the latch downward with your finger nail.
2. Gently remove the boot from the hearing instrument.

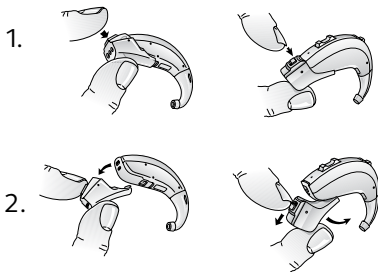

## Beep/tone indicators

<b>BEEP/TONE</b>	<b>INDICATION</b>	<b>ACTION REQUIRED</b>
Ding, ding, ding, dong	Low battery	Change battery
Ding (5 or 10)	Hearing aid is starting up	After dings cease, hearing aid is turned on
Ding-ding, ding-ding, etc.	Hearing aid is in flight mode	Use in flight mode if desired, or open-close battery door to exit flight mode
Ripple tone	Hearing aid is in streaming mode	Use with wireless accessory or press multi-function button to exit streaming mode



## Troubleshooting

<b>SYMPTOM</b>	<b>CAUSE</b>	<b>POSSIBLE REMEDY</b>
No sound	Battery door not closed Dead battery Battery door will not close Blocked earmold or tube	Turn on by closing the battery door (D) Replace battery Insert battery properly Clean earmold or tube (H)
Not loud enough	Blocked earmold Change in hearing, volume too low Excessive ear wax	Clean earmold (H) Consult your hearing care professional Consult your hearing care professional
Excessive whistling/feedback	Incorrect earmold placement Excessive ear wax If none of the above	Re-insert earmold carefully Clean guard/consult your hearing care professional Consult your hearing care professional
Wireless does not work	Device may be in flight mode	Open and close the battery compartment once. Wireless operation will reactivate ten seconds later.

If there are any other problems not mentioned in this guide, please contact ReSound or your hearing care professional.

For more information

**Refer to the user guide included in your hearing aid box.**

**Your hearing care professional can be reached at:**

---

---

---

---

View ReSound hearing aid tutorial videos at [youtube.com/resoundus](https://youtube.com/resoundus).

**Manufacturer according to FDA**

**ReSound North America**

8001 E. Bloomington Freeway  
Bloomington, MN 55420  
1.888.735.4327  
[resound.com](https://resound.com)

**Manufacturer according to Health Canada**

**ReSound Canada**

303 Supertest Road  
Toronto, Ontario M3J 2M4  
1.888.737.6863  
[resound.com](https://resound.com)

**ReSound Government Services**

8001 E. Bloomington Freeway  
Bloomington, MN 55420  
1.800.392.9932  
[www.resound.com/veterans](https://www.resound.com/veterans)

