



Quick guide

ReSound OMNIA
77 Rechargeable BTE

GN Making Life Sound Better

My hearing aid information

Product: ReSound OMNIA

Model: RU77-DWC

Serial number (R):

Serial number (L):

Battery size: Lithium-ion

Programs:

(if set up by your hearing care professional)

PROGRAM	WHEN TO USE	BEEPS
1		1
2		2
3		3
4		4

Get to know your hearing aid

BTE models with hook

1. Earmold
2. Tube
3. Microphone inlets
4. LED green indicator light
5. Push button
6. Left/Right identification
Left = blue. Right = red.

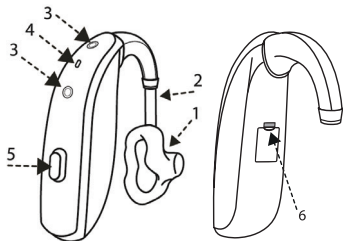

BTE Thin tube model

1. Dome*
2. Thin tube
3. Microphone inlets
4. LED green indicator light
5. Push button
6. See previous page.
(Left/Right identification)

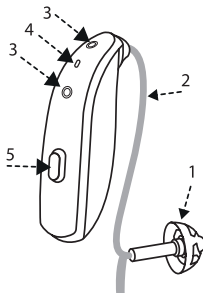

*Open dome is shown - yours may look different.

View ReSound's hearing aid tutorial videos at youtube.com/resoundus.

Desktop Hearing aid charger

1. Hearing aid charging bay
2. Left indicator (blue)
3. Right indicator (red)
4. Power ON - LED light
5. Charging cable
6. Charging cable port (USB-C)

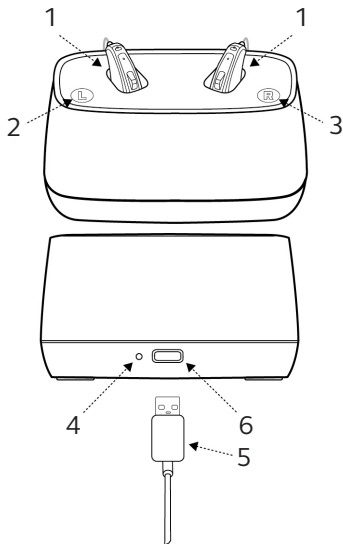

What you need to know

Getting started: On/Off function

Your hearing aids are automatically turned on when they are removed from the hearing aid charger. They can also be turned on and off manually by pressing the push button for 5 seconds.

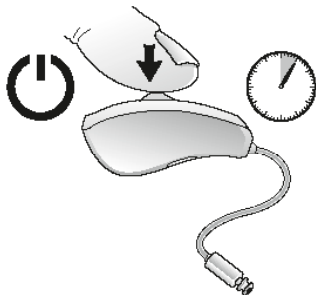

How to charge your hearing aids

- Plug the power adaptor into a power outlet and connect the charging cable to the hearing aid charger.
- Place both hearing aids in the charging bays. The right side is marked with a red dot and the left side is marked by a blue dot.

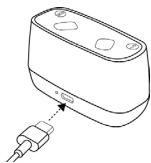

- The LED on the hearing aids slowly pulsates when charging and will stay solid when fully charged.



When charging
Pulsating



When fully charged
On-until removed

Flight mode:

Some airlines prohibit the use of wireless hearing aids (RF transmitters) onboard.

To use Flight mode, make sure this is activated by your hearing care professional.

Follow these steps to turn on Flight mode:

1. Turn the hearing aid off.
2. Press the push button for 9 seconds.
3. The hearing aid responds with four times double flashes and double-dings for ten seconds.

To deactivate Flight mode:

1. Turn the hearing aids off and then on.

Regular care & maintenance

Daily: Clean your hearing aid.

Keep your hearing aids dry. Clean the hearing aids using a soft cloth or tissue.

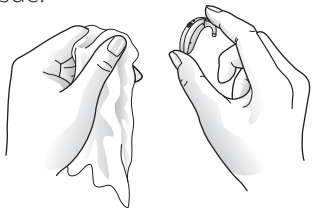

Weekly: Clean the thin tubes and domes/earmold.

1. Remove thin tubes from hearing instruments before cleaning by unscrewing them counter clockwise.
2. Wipe down thin tubes and domes with a soft cloth.
3. In order to clear the thin tube of moisture and debris, push the black cleaning rod through the thin tube, beginning at the end opposite the dome.

As needed: Change dome (if applicable)

ReSound standard domes

1. Push the new dome on to the thin tube.
2. Make sure that the new dome is properly and securely maintained.



ReSound tulip domes

Tulip domes consist of two “petals”. It is important that the largest petal is the outermost petal. To ensure this:

1. Push the largest petal away from the thin tube using a finger. This bends the petal forward.
2. Then push the largest “petal” back, and it will be placed on top of the smaller petal.

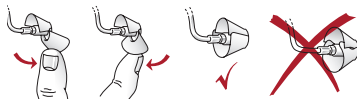

Changing the microphone filter

1. Open the filter case and take out one of the tools. Each tool has a small hook (removal tip) in one end and a new microphone filter in the other.

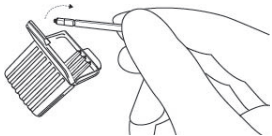

2. Insert the removal tip into the used microphone filter and then pull the tool straight out. It is important to pull it straight and not on an angle.

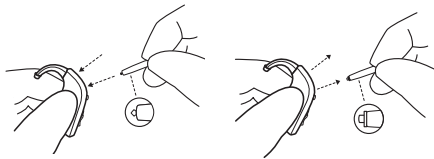

NOTE: Pressing on the new microphone filter with the flat side of the filter tool can ensure that the filter is correctly in place.

3. Insert the other end of the tool (the end with the replacement filter) into the microphone opening.

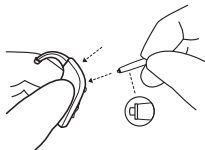

4. Gently press the replacement filter straight into the microphone opening until the outer ring is flush with the back of the hearing aid.

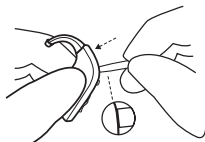

5. Pull the tool straight out – your new microphone filter should remain in place.

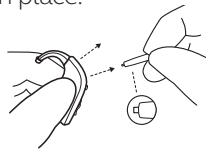

Beep/tone indicators

BEEP/TONE	INDICATION	ACTION REQUIRED
Ding, ding, ding, dong	Low battery	Charge battery
Ding (5 or 10)	Hearing aid is starting up	After dings cease, hearing aid is turned on
Ding-ding, ding-ding, etc.	Hearing aid is in flight mode	Use in flight mode if desired, or turn the hearing aids off and then on
Ripple tone	Hearing aid is in streaming mode	Use with wireless accessory or press the push button to exit streaming mode

Troubleshooting

SYMPTOM	CAUSE
Feedback “whistling”	<p>Is your earmould inserted correctly in the ear?</p> <p>Is the volume very loud?</p> <p>Are you holding an object (e.g. a hat or a phone) close to a hearing aid?</p> <p>Is your ear full of wax?</p>
No sound	<p>Is the hearing aid turned off?</p> <p>Is the hearing aid in telecoil mode?</p> <p>Is the hearing aid charged?</p> <p>Is the plastic tube or earmould clogged or broken?</p> <p>Is your ear full of wax?</p>
Sound is distorted or weak	<p>Is the plastic tube or earmould clogged or broken?</p> <p>Did your hearing aid get moist?</p>
Battery drains very quickly	<p>Did you leave your hearing aid turned on for long periods of time?</p> <p>Is the hearing aid old?</p>
Hearing aid is not charging	<p>Does the hearing aid sit correctly in the charger?</p> <p>Is the hearing aid charger plugged into a power source?</p>
Still having an unresolved issue?	

POSSIBLE REMEDY

Re-insert it.

If you have increased the volume, try reducing it.

Move your hand away to create more space between the hearing aid and the object.

Visit your hearing care professional or physician to have your ears checked for wax. Some people experience more wax after being fitted with hearing aids.

Turn it on.

Switch to the microphone program.

Place the hearing aid in the charger for charging.

Consult your hearing care professional.

Visit your physician.

Consult your hearing care professional.

Use a desiccant (drying kit).

Always place your hearing aids in the charger for recharging when you are not using them, e.g. during the night, or switch them off.

Visit your hearing care professional.

Reinsert the hearing aid in the charger.

Plug the charger into a power source.

Consult your hearing care professional

For more information

**Refer to the user guide included in
your hearing aid box.**

**Your hearing care professional can
be reached at:**

View ReSound hearing aid tutorial
videos at youtube.com/resoundus.

Manufacturer according to FDA:

GN ReSound North America

8001 E Bloomington Freeway

Bloomington, MN 55420

USA

1.888.735.4327

resound.com

ReSound Government Services

8001 E Bloomington Freeway

Bloomington, MN 55420

USA

1.800.392.9932

www.resound.com/veterans



402316011

402316011 Rev A 2023.01