



My hearing aid information

Product: ReSound Key

Model: 61

Serial number (R):

Serial number (L):

Battery size: Lithium-ion



Quick guide
ReSound Key 61

GN Making Life Sound Better

Programs:

(if set up by your hearing care professional)

PROGRAM	WHEN TO USE	BEEPS
1		1
2		2
3		3
4		4

Get to know your hearing aid

1. Push button
2. Receiver
3. Open dome
4. Receiver wire
5. LED light indicator
6. Microphones
7. Right/Left indicator
8. Serial number and model

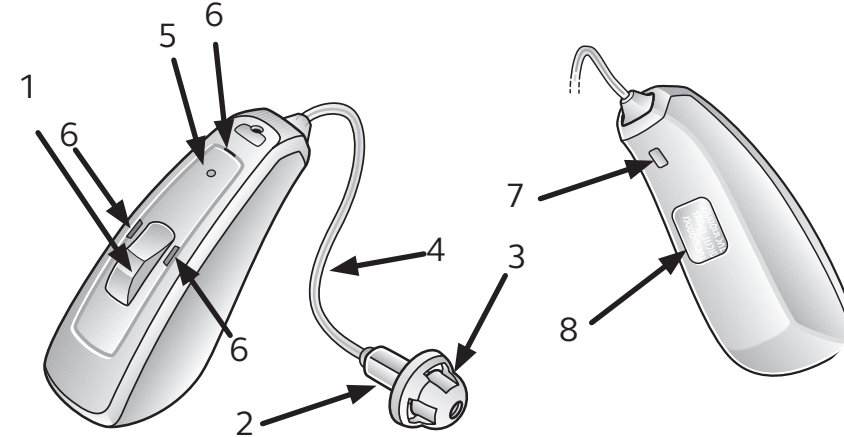

View ReSound's hearing aid tutorial videos at youtube.com/resoundus.

6.2 Desktop Hearing aid charger

1. Hearing aid charging bay
2. Left indicator (blue)
3. Right indicator (red)
4. Power ON - LED light
5. Charging cable
6. Charging cable port (micro-USB)

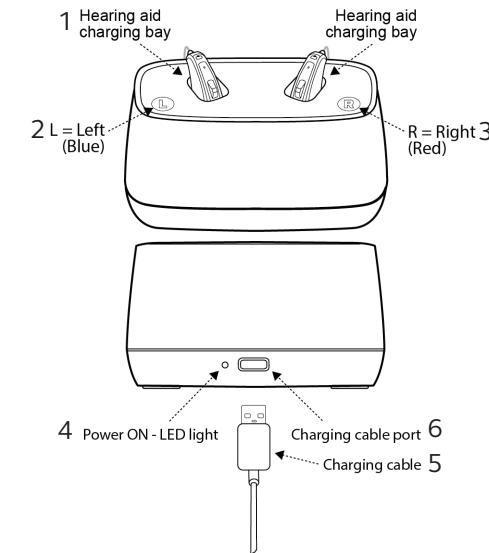

What you need to know

Getting started: On/Off function

Your hearing aids are automatically turned on when they are removed from the hearing aid charger. They can also be turned on and off manually by pressing the push button for 5 seconds.

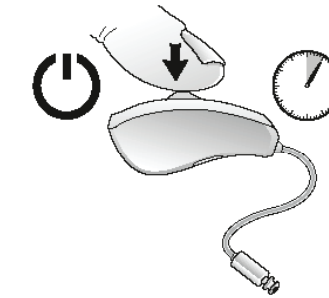

How to charge your hearing aids

- Plug the power adaptor into a power outlet and connect the charging cable to the hearing aid charger.

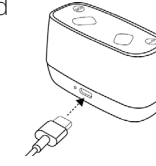

- Place both hearing aids in the charging bays. The right side is marked with a red dot and the left side is marked by a blue dot.

- The LED on the hearing aids slowly pulsates when charging and will stay solid when fully charged.



When charging
Pulsating



When fully charged
On-until removed

Regular care & maintenance

Daily: Clean your hearing aid.

Keep your hearing aids dry. Clean the hearing aids using a soft cloth or tissue.

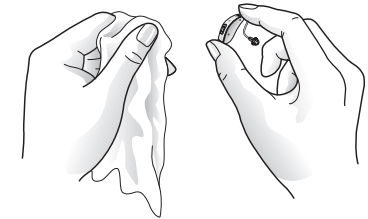

Weekly: Clean the receiver tubes and domes (3).

Use a soft cloth to clean the receiver tube and dome on the outside. Do not use water when you are cleaning the receiver tubes.

For more information

Refer to the user guide included in your hearing aid box.

Your hearing care professional can be reached at:

View ReSound hearing aid tutorial videos at youtube.com/resoundus.

Manufacturer according to FDA:

GN ReSound North America
8001 E Bloomington Freeway
Bloomington, MN 55420
USA
1.888.735.4327
resound.com

ReSound Government Services
8001 E Bloomington Freeway
Bloomington, MN 55420
USA
1.800.392.9932
www.resound.com/veterans



401617011 Rev A 2020.12

Regular care & maintenance

As needed: Change dome (3)

ReSound standard domes

1. Push the new dome over the receiver.
2. Make sure that the new dome is properly and securely maintained.

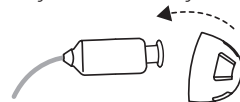

ReSound tulip domes

Tulip domes consist of two “petals”. It is important that the largest petal is the outermost petal. To ensure this:

1. Push the largest petal away from the receiver tube using a finger. This bends the petal forward.
2. Then push the largest petal back, and it will be placed on top of the smaller petal.

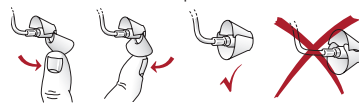

Monthly: Change the wax guard or see your hearing care professional.

For changing CeruSTOP™ (white) wax guards, complete the following steps:

Removal: Insert the removal side of the wax guard tool into the used wax guard so that the shaft of the tool is touching the rim of the wax guard. Slowly pull the wax guard straight out.

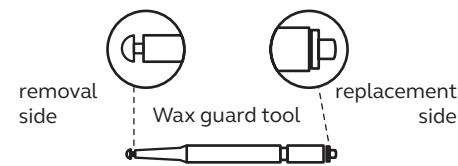

Insertion: To insert the new wax guard, gently press the replacement side of the wax guard tool straight into the hole of the sound outlet until the outer ring lies flush with the outside of the receiver. Pull the tool straight out. The new wax guard will remain in place.

Flight mode:

Some airlines prohibit the use of wireless hearing aids (RF transmitters) onboard.

To use Flight mode, make sure this is activated by your hearing care professional.

Follow these steps to turn on Flight mode:

1. Turn the hearing aid off.
2. Press the push button for 9 seconds.
3. The hearing aid responds with four times double flashes and double-dings for ten seconds.

To deactivate Flight mode:

1. Turn the hearing aids off and then on.

Beep/tone indicators

BEEP/TONE	INDICATION	ACTION REQUIRED
Ding, ding, ding, dong	Low battery	Charge battery
Ding (5 or 10)	Hearing aid is starting up	After dings cease, hearing aid is turned on
Ding-ding, ding-ding, etc.	Hearing aid is in flight mode	Use in flight mode if desired, or turn the hearing aids off and then on
Ripple tone	Hearing aid is in streaming mode	Use with wireless accessory or press the push button to exit streaming mode

View ReSound hearing aid tutorial videos at youtube.com/resoundus.

If there are any other problems not mentioned in this guide, please contact ReSound or your hearing care professional.

Troubleshooting

SYMPTOM	CAUSE	POSSIBLE REMEDY
No sound	Blocked earmold or tube Blocked wax guard	Clean earmold or tube Replace wax guard or consult your hearing care professional
Not loud enough	Blocked earmold or dome (3) Change in hearing, volume too low Excessive ear wax	Clean earmold, replace dome (3), replace guard Consult your hearing care professional Consult your hearing care professional
Excessive whistling/feedback	Incorrect earmold placement Incorrect dome (3) placement Excessive ear wax If none of the above	Re-insert earmold carefully Re-insert dome (3) Clean earmold (if applicable), replace dome (3), replace guard /consult your hearing care professional Consult your hearing care professional
Wireless does not work	Device may be in flight mode	Turn the hearing aid off and then back on
Hearing aid is not charging	Does the hearing aid sit correctly in the charger? Is the hearing aid charger plugged in?	Reinsert the hearing aid in the charger. Plug the charger into a power outlet and connect the charger cable to the hearing aid charger.
Why do my hearing aids not turn on automatically, although they have been in the charger for an extended period of time?	If you leave your hearing aids in the charger for more than 24 hours, the charger will go into standby mode and turn off the power of the hearing aids. If the charger runs out of battery power during charging of the hearing aids, it will instruct the hearing aids to turn off power to preserve energy.	Remove the hearing aids from the charger and press the push button for 5 seconds to turn the hearing aids on manually.