



## Quick guide

ReSound LiNX Quattro™ CIC

# My hearing aid information

**Product:** ReSound LiNX Quattro

**Model:** CIC-W

**Serial number (R):**

---

**Serial number (L):**

---

**Battery size:** 10A

## Program button (A):

ACTION	RESULT
SHORT push	Program change
LONG push	Activate streaming (if enabled by professional)

## Programs:

(if set up by your hearing care professional)

PROGRAM	WHEN TO USE	BEEPS
1		1
2		2
3		3
4		4

## What you need to know

**Getting started:** On/Off function

**ON:** Insert battery & completely close battery door (B). Program 1 will be active.



**OFF:** Open the battery door (B). Use fingertip to pull it all the way.

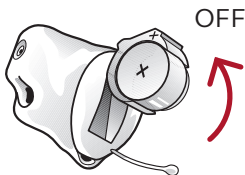

## Inserting/Replacing the battery:

1. Open the battery door (B) completely by using your fingertip.



2. Remove protective sticker from battery and wait two minutes before inserting the battery into the hearing aid to allow full activation of the battery.



3. Insert the new battery with the positive side (flat side) in the correct position, as shown.



4. Gently close the battery door (B). If it doesn't close easily, check to see if the battery is upside down.

## Get to know your hearing aid

- A. Push button (optional)
- B. Battery door and On/Off switch
- C. Removal cord (optional)
- D. Sound outlet
- E. Wax filter
- F. Vent
- G. Microphone sound inlet(s)
- H. Manufacturer
- I. Serial number
- J. Antenna

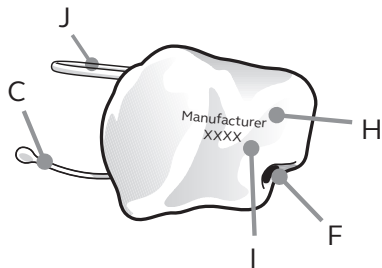
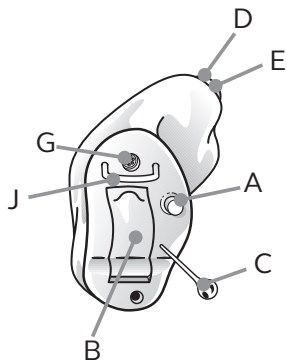

View ReSound hearing aid tutorial videos at [youtube.com/resoundus](https://youtube.com/resoundus).

## Flight mode:

(if set up by your hearing care professional)

Some airlines prohibit the use of wireless hearing aids (RF transmitters) onboard. If required by your airline, enable flight mode:

**Disable wireless operation** by opening and closing the battery door three times within ten seconds (open-close, open-close, open-close). Your instruments will now be in flight mode.

The hearing aids must function in flight mode for ten seconds before wireless operation can be re-enabled.

**To re-enable wireless operation**, open and close the battery door one time and wait thirty seconds before opening the battery door again to avoid accidentally entering flight mode again.

## Regular care & maintenance

**Daily:** Clean your hearing aid.

Keep your hearing aids dry. Clean the hearing aids using a soft cloth or tissue.

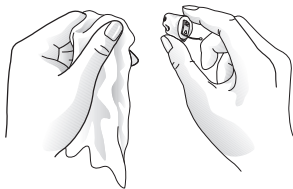

**Monthly:** Change the wax guard (E) or see your hearing care professional.

For changing the (white) wax guard (E), complete the following steps:

**Removal:** Insert the removal side of the wax guard tool into the used wax guard (E) so that the shaft of the tool is touching the rim of the wax guard. Slowly pull the wax guard straight out.



**Insertion:** To insert the new wax guard (E), gently press the replacement side of the wax guard tool straight into the hole of the sound outlet until the outer ring lies flush with the outside of the receiver. Pull the tool straight out. The new wax guard will remain in place.

**For changing HF3 wax guard (E), complete the following steps:**

1. Brush the sound outlet area with the sound outlet pointed down.

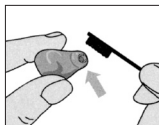

2. Insert the threaded end of the wax guard tool into the used wax guard, (E) and rotate clockwise.

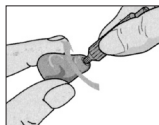
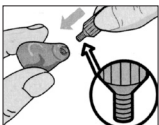

3. Gently pull until the used guard is removed.

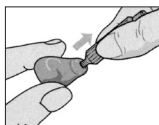

4. Discard the used guard in the slot located

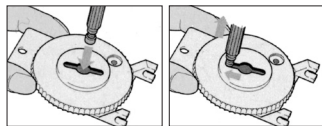

in the wax guard kit by pressing it into the center, sliding it to one end of the slot, and pull until the filter is discarded.

5. Flip the wax guard tool around, locate a new guard in the dial, and press the tip of the tool into the center of the dial.

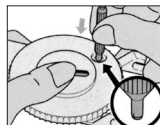

6. Gently pull the new guard out of the dial.

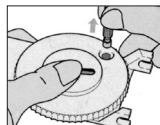

7. Press the new guard to the canal tip of the hearing aid. Move the tool gently side to side and pull it away from the hearing aid.

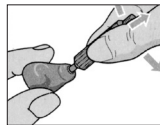
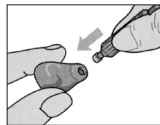

## Beep/tone indicators

<b>BEEP/TONE</b>	<b>INDICATION</b>	<b>ACTION REQUIRED</b>
Ding, ding, ding, dong	Low battery	Change battery
Ding (5 or 10)	Hearing aid is starting up	After dings cease, hearing aid is turned on
Ding-ding, ding-ding, etc.	Hearing aid is in flight mode	Use in flight mode if desired, or open-close battery door (B) to exit flight mode
Ripple tone	Hearing aid is in streaming mode	Use with wireless accessory or press multi-function button to exit streaming mode

View ReSound hearing aid tutorial videos at [youtube.com/resoundus](https://youtube.com/resoundus).

## Troubleshooting

<b>SYMPTOM</b>	<b>CAUSE</b>	<b>POSSIBLE REMEDY</b>
No sound	Battery door (B) not closed	Turn on by closing the battery door (B)
	Dead battery	Replace battery
	Battery door (B) will not close	Insert battery properly
Not loud enough	Blocked wax guard (E)	Replace wax guard (E) or consult your hearing care professional
	Blocked sound outlet (D)	Change wax guard (E) or consult your hearing professional
	Change in hearing, volume too low	Consult your hearing care professional
Excessive whistling/feedback	Excessive ear wax	Consult your hearing care professional
	Incorrect placement in ear	Re-insert hearing aid carefully
	Excessive ear wax	Clean guard (E)/consult your hearing care professional
	If none of the above	Consult your hearing care professional

If there are any other problems not mentioned in this guide, please contact ReSound or your hearing care professional.



# For more information

**Refer to the user guide included in your hearing aid box.**

**Your hearing care professional can be reached at:**

---

---

---

---

View ReSound hearing aid tutorial videos at [youtube.com/resoundus](https://youtube.com/resoundus).

**Manufacturer according to FDA:**

**ReSound North America**

8001 E. Bloomington Freeway  
Bloomington, MN 55420  
1.888.735.4327  
[resound.com](https://resound.com)

**ReSound Government Services**

8001 E. Bloomington Freeway  
Bloomington, MN 55420  
1.800.392.9932  
[www.resound.com/veterans](https://www.resound.com/veterans)



401227011

401227011 Rev B 2020.01