



BOTTOMPRESS

BBB BOTTOM BRACKET
/BBO-21/25

BBB CYCLING.COM
ROOSEVELTSTRAAT 46, 2321 BM
LEIDEN, THE NETHERLANDS

EN MANUAL / DE HANDBUCH / FR MANUEL / NL HANDLEIDING / ES MANUAL / PT MANUAL /
IT MANUALE / HU HASZNÁLATI UTASÍTÁS / PL PODRECZNIK / CZ UŽIVATELSKÁ PŘÍRUČKA
/ JP 使用説明書 / RU РУКОВОДСТВО ПОЛЬЗОВАТЕЛЯ / SK MANUÁL / NO HÅNDBOK

IMPORTANT:

- * Before installing the bearings, use a reaming tool to ensure the bottom bracket (BB) shell is clean and free of metal chips, dirt and excess paint.
- * Inspect the BB shell for ID, ovalization or anything that could cause bearing mis-alignment.
- * Always use a calibrated torque wrench to tighten crank bolts.
- * The wave spring washer should not be completely compressed for proper use.

FIND YOUR TRANSLATION
ON BBBCYCLING.COM



WARNING

Sold only by professional bicycle dealers.
For proper installation, ask your BBB dealer.
Not following the instructions in this manual
may cause damage to the product not covered
under warranty, damage to the bicycle, or
cause an accident resulting in injury or death.

COMPONENTS:

- | | |
|------------------------------|---------------------------|
| ① Bottom bracket shell | ④ Compression seal (x1) |
| ② Plastic center sleeve (x1) | ⑤ MW112 2.5mm shim (x1) |
| ③ Bearing cup (x2) | ⑥ Wave spring washer (x1) |

COMPATIBILITY

BBO-21 is for 86.5mm wide BB shells ① .
BBO-25 is for 89.5/92mm wide BB shells ① .

RECOMMENDED TOOLS

- | | |
|---------------------|----------------------------|
| - BTL-95 BracketKit | - Grease |
| - Adjustable wrench | - PTFE (Carbon BB shell) |
| - Torque wrench | - Anti-seize (Ti BB shell) |

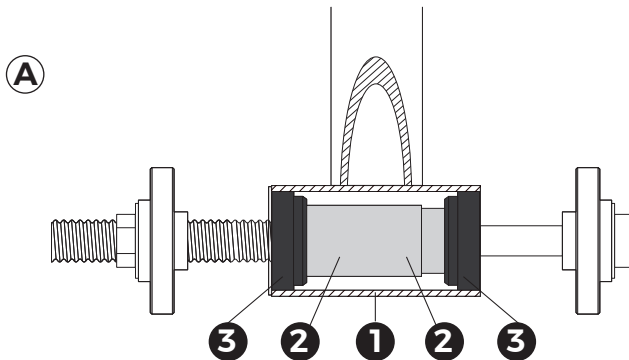

A: BOTTOM BRACKET INSTALLATION

1. Place the bearing cup ③ with the plastic sleeve ② on the headset press tool.
2. Slide the headset press tool through the BB shell ① and place the remaining bearing cup ③ with the plastic sleeve ② facing the BB shell.
3. Use the headset press tool to press the bearing cups ③ with plastic center sleeve ② into the BB shell. Tighten until the the bearing cup ③ is flush with the outer face of the BB shell ①.
4. When the bottom bracket is fully installed, unscrew the headset press tool and carefully remove.
5. Check the bearings for rotational smoothness. If the bearings feel rough, it may be an indication the cups are not perfectly aligned in the BB shell. It may be necessary to reinstall the bearings to assure the bearing cups are properly aligned.

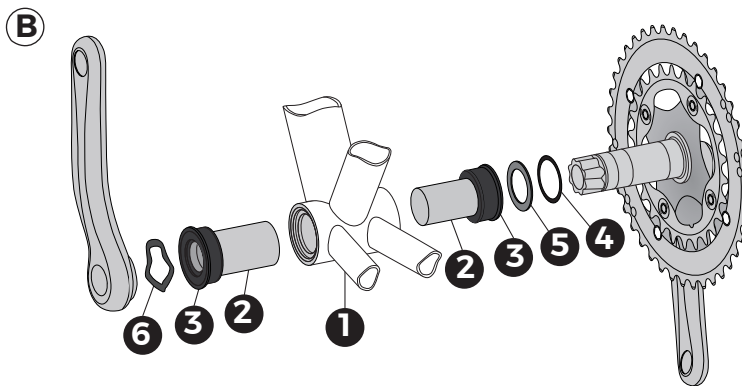

B: CRANKSET INSTALLATION

1. Apply grease to the surfaces of the spindle that will contact the bearings and on the spindle engagement teeth.
2. Place the compression seal ④ on the spindle with the blue side facing the crank. Place the MW112 shim ⑤ ONLY if the measured BB shell ① width was 89.5mm.
3. Insert the drive crank into the drive side of BB shell. Take care not to damage the plastic covers of the bearing cups.
4. Insert the wave spring washer ⑥ on the non-drive side of the spindle. Make sure the engagement teeth are fully exposed on the non-drive side of the bottom bracket.
5. Install the left crank arm and tighten to manufacturer specifications. If necessary, install separately available shims to take up any play. If there is still play, DO NOT tighten even more, inspect BB shell for proper tolerances and re-install BB and crankset.