



DigiMagnet

Wheel Magnet

- | | |
|-----------------------|------------------------------------|
| EN Manual | HU Használati utasítás |
| DE Handbuch | PL Podręcznik |
| FR Manuel | CZ Uživatelská příručka |
| NL Handleiding | JP 使用説明書 |
| ES Manual | RU Руководство пользователя |
| PT Manual | SK Manuál |
| IT Manuale | NO Håndbok |

BCP-60

Quick Start Manual (English)

Download the complete manual at www.BBBparts.com

- | | |
|-----------------------------------|------------------------------|
| EN Wheel magnet. | HU Kerékmágnes. |
| DE Computerspeichenmagnet. | PL Magnes na szprycę. |
| FR Aimant pour roue. | CZ Magnet na kolo. |
| NL Wiel magneet. | JP ホイールマグネット。 |
| ES Imán de rueda. | RU Магнит на колесо. |
| PT Magneto de roda. | SK Magnet na koleso. |
| IT Magnete. | NO Hjulmagnet. |

MOUNTING WHEEL MAGNET

1. Install the wheel magnet on a spoke, using a Phillips screwdriver.
2. Position the speed sensor on the fork leg to achieve the correct alignment with the wheel magnet. If needed, move the wheel magnet. The distance between the wheel magnet and the sensor point should be maximum 5mm.

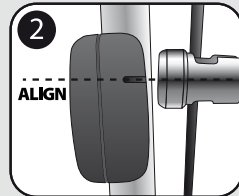
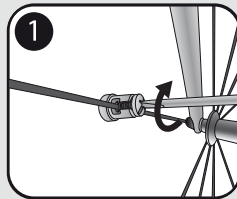

www.BBBPARTS.COM

© BBB Bike Parts

The specifications and designs may be changed without notice.
BBB has no responsibility for misprints or changed technical content.