



# BOTTOMLINK BOTTOM AXLE

**BBB CYCLING®**

ROOSEVELTSTRAAT 46, 2321 BW LEIDEN  
THE NETHERLANDS

**BBBCYCLING.COM**

- EN Manual
- DE Handbuch
- FR Manuel
- NL Handleiding
- ES Manual
- PT Manual
- IT Manuale

- HU Használati utasítás
- PL Podręcznik
- CZ Uživatelská příručka
- JP 使用説明書
- RU Руководство пользователя
- SK Manuál
- NO Håndbok

**BBO-61**

**BB SHELL**

**CRANKSET**

INNER Ø	46MM	46MM	42MM	41MM	37MM	1,37" X 24T
WIDTH	68 - 73MM	86,5MM	68 - 73MM	86,5 - 89,5 - 92MM	90 - 95MM	86 - 73MM
<b>TYPE</b>	<b>PF30</b>	<b>BB386 EVO</b>	<b>BB30</b>	<b>BB86 - 89,5 - 92</b>	<b>BB90 - 95</b>	<b>THREADED</b>
<b>BIKE</b>	<b>ROAD   MTB</b>	<b>ROAD</b>	<b>ROAD   MTB</b>	<b>ROAD   MTB</b>	<b>ROAD   MTB</b>	<b>ROAD   MTB</b>
- SHIMANO Hollowtech II - FSA Mega Exo - RACE FACE X-Type - ROTOR 3D - Agilla	BBO-01   BBO-05 + BBO-16   BBO-16	BBO-01 + BBO-17	BBO-11   BBO-15 + BBO-16   BBO-16	BBO-21   BBO-25	BBO-26	BBO-31   BBO-35
Spindle dia = 24mm						
- FSA BB30 - SRAM BB30	BBO-01   BBO-05		BBO-11   BBO-15			
Spindle dia = 30mm						
- FSA BB386 EVO		BBO-01				
Spindle dia = 30mm						

**MORE BOTTOM BRACKETS**

CAMPAGNOLO: Ultra Torque - BBO-41  
Power Torque - BBO-42

SQUARE TAPERED JIS: 113mm - BBO-51  
Shimano 115mm - BBO-52  
Ritchey 118mm - BBO-53  
Specialized 122.5mm - BBO-54

ISIS DRIVE: BBO-61  
Bontrager (Truvativ) Truvativ  
FSA

**ENGLISH**

**WARNING**

Sold only by professional bicycle dealers. For proper installation, ask your BBB dealer. Not following the instructions in this manual may cause damage to the product not covered under warranty, damage to the bicycle, or cause an accident resulting in injury or death.

**INSTALLATION:**

- The threads in the bottom bracket shell of your frame must be clean, lightly greased, and free of paint and dirt. The shell must have English threads and the ends must be faced. If your frame is new, check the threads and the outside ends to be sure they are chased and faced.
- This bottom bracket has different threads on the right and left side, and it is important that these threads are installed in the correct side of the frame. The BB is labeled to distinguish the right and left sides, as shown in illustration A. The right side of the bicycle is the drivetrain side.
- Apply threadlock compound to the outside thread of the left bottom bracket adapter and lightly grease the inside surface. Thread it clockwise by hand into the left side of the frame. See illustration B for your reference.
- Apply threadlock compound to the bottom bracket threads and insert the BB into the bottom bracket shell through the right side. Turn the threads counterclockwise and thread the BB by hand into the frame all the way. After the BB is threaded into the frame, lightly grease the stops at each end of the spindle. See illustration C for your reference.
- After assembling the bottom bracket into the frame, both sides must be tightened correctly with help of a torque wrench and bottom bracket tool to assure the BB does not come loose or get damaged. Ask your frame manufacturer for the appropriate torque.

The BB installation is now finished. Please check your crankset manual for installation of the cranks.

**COMPONENTS:**

Follow the assembly order in the illustrations:

- Bottom bracket (BB) shell
- Bottom bracket
- Left bottom bracket adapter

**TOOLS:**

- Bottom bracket installation tool
- Torque wrench

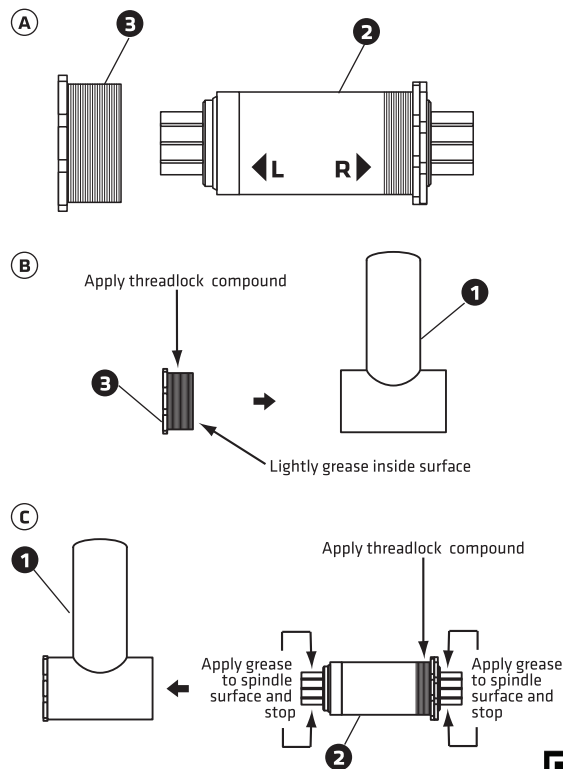

Find your translation on  
BBBcycling.com

BBB has no responsibility for misprints or changed technical content.