

BBB

BOTTOMPRESS BOTTOM BRACKET

BBB CYCLING®
ROOSEVELTSTRAAT 46, 2321 BM LEIDEN
THE NETHERLANDS

BBBCYCLING.COM

EN Manual	HU Használati utasítás
DE Handbuch	PL Podręcznik
FR Manuel	CZ Uživatelská příručka
NL Handleiding	JP 使用説明書
ES Manual	RU Руководство пользователя
PT Manual	SK Manuál
IT Manuale	NO Håndbok

BBO-22

COMPONENTS:

- 1 Bottom bracket shell
- 2 Plastic center sleeve (x1)
- 3 DS bearing cup (x1)
- 4 NDS bearing cup (x1)
- 5 2.5mm spacer (x1)
- 6 Wave spring washer (x1)

COMPATIBILITY

BBO-22 is for 86.5/89.5/92mm wide BB shells ① to fit 22/24mm stepped spindle cranksets (SRAM/Truvativ).

RECOMMENDED TOOLS

- BTL-95 BracketKit
- Grease
- Adjustable wrench
- PTFE (Carbon BB shell)
- Torque wrench
- Anti-seize (Ti BB shell)

A

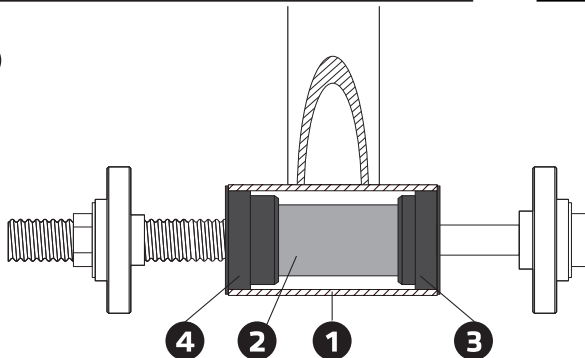

A: BOTTOM BRACKET INSTALLATION

1. Apply a thin layer of grease, PTFE (for Carbon) or anti-seize compound (for Ti) on the inside surface of BB shell ①. Place the bearing cup ③/④ with the plastic sleeve ② on the headset press tool.
2. Slide the headset press tool through the BB shell ① and place the remaining bearing cup ③/④ with the plastic sleeve ② facing the BB shell.
3. Use the headset press tool to press the bearing cups ③/④ with plastic center sleeve ② into the BB shell ①. Tighten until the flange of the cup is flush with the outer face of the BB shell ①.
4. When the bottom bracket is fully installed, unscrew the headset press tool and carefully remove.
5. Check the bearings for rotational smoothness. If the bearings feel rough, it may be an indication the cups are not perfectly aligned in the BB shell. It may be necessary to reinstall the bearings to assure the bearing cups are properly aligned.

B

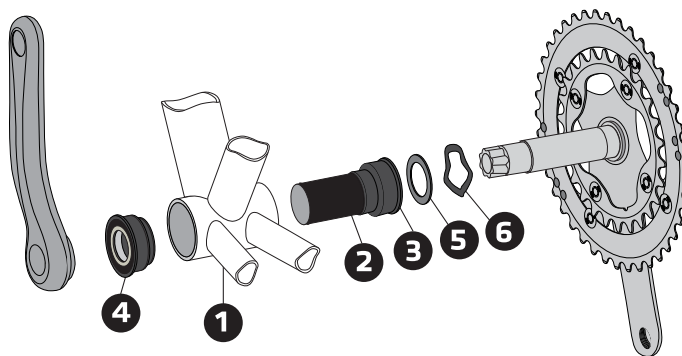

B: CRANKSET INSTALLATION

1. Apply grease to the surfaces of the spindle that will contact the bearings and on the spindle engagement teeth.
2. Place the wave spring washer ⑥ on the drive side of the spindle 3. Place the 2.5mm spacer ⑤ ONLY if the measured BB shell ① width was 89.5mm.
3. Insert the drive crank into the drive side of BB shell. Take care not to damage the plastic covers of the bearing cups.
4. Make sure the engagement teeth are fully exposed on the non-drive side of the bottom bracket.
5. Install the left crank arm and tighten to manufacturer specifications. If there is play, DO NOT tighten even more, inspect BB shell for proper specifications and tolerances and re-install BB and crankset.

Find your translation
on BBBcycling.com



WARNING

Sold only by professional bicycle dealers.
For proper installation, ask your BBB dealer.
Not following the instructions in this manual
may cause damage to the product not covered under
warranty, damage to the bicycle, or cause an
accident resulting in injury or death.