

III. Exploded view

"ACROS SETUP"

Parts to remove and destroy in the recall are in red type.
DO NOT use them anymore along with FOCUS carbon steerer tubes.

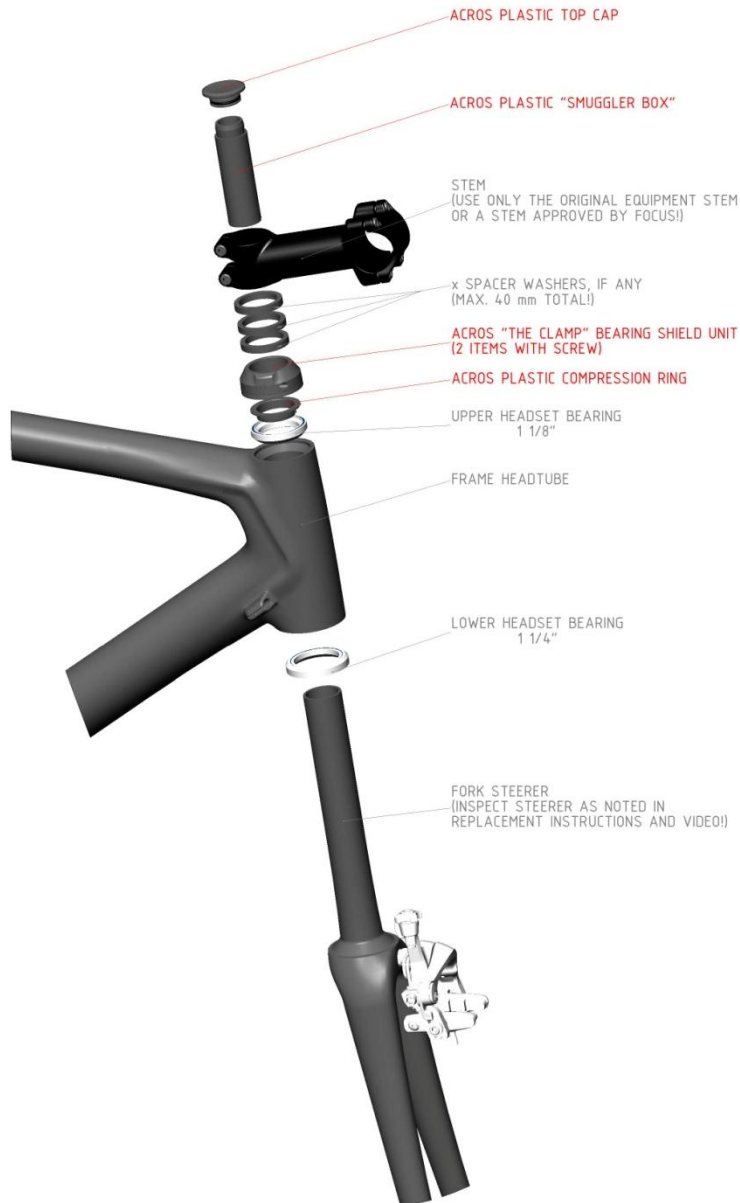

"REPLACEMENT SETUP"

Replacement parts provided in the recall are in green type.
DO NOT use any other part other than those provided in this recall or originally on the bike.

