



## BOTTOMFIT

# BBB BOTTOM BRACKET /BB0-29SR

BBB CYCLING.COM  
ROOSEVELTSTRAAT 46, 2321 BM  
LEIDEN, THE NETHERLANDS

EN MANUAL / DE HANDBUCH / FR MANUEL / NL HANDLEIDING / ES MANUAL / PT MANUAL / IT MANUALE / HU HASZNÁLATI UTASÍTÁS / PL PODRECZNIK / CZ UŽIVATELSKÁ PŘÍRUČKA / JP 使用説明書 / RU РУКОВОДСТВО ПОЛЬЗОВАТЕЛЯ / SK MANUÁL / NO HÅNDBOK

### COMPONENTS:

- ① Bottom bracket shell
- ② Non-drive side cup (x1)
- ③ Drive side cup (x1)
- ④ 2.5mm spacer
- ⑤ ShimSet spacers
- ⑥ Wave spring washer

● Included    ● Not Included

### COMPATIBILITY:

BB86/92 (86.5/89.5/92 x Ø41mm) +  
Ø24-22 mm spindle cranksets

### RECOMMENDED TOOLS:

- BTL-27L x 2
- Grease
- BTL-95 Bottompress toolset
- PTFE (Carbon BB shell)
- Anti-seize (Ti BB shell)

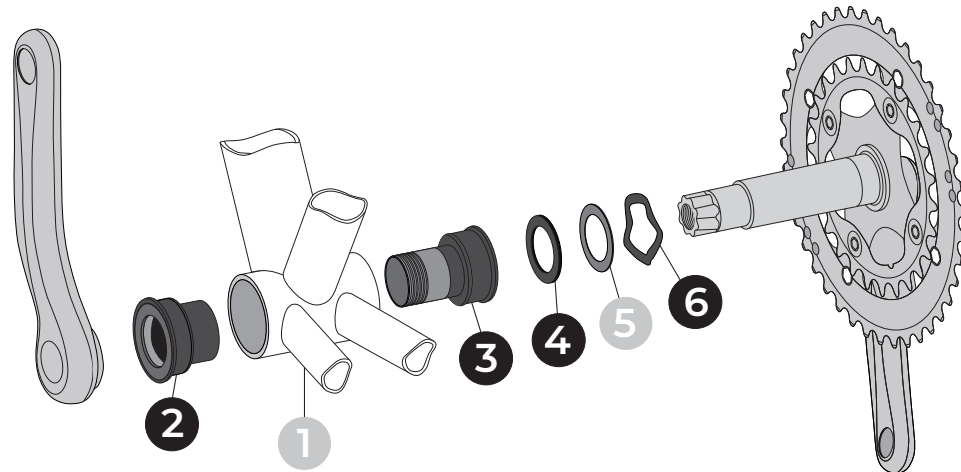

### IMPORTANT:

- Before installing ensure the BB shell ① is clean and free of metal chips, dirt and excess paint.
- Inspect the BB shell ① for width, inner diameter, ovalization or anything that could cause bearing mis-alignment.
- Always use a calibrated torque wrench to tighten crank bolts.
- BBB Cycling cannot guarantee compatibility with you frame and/or crank combination.
- consult your manufacturer for compatibility.
- BBB Cycling cannot be held responsible for any damage occurred during assembly.
- The wave washer should not be completely compressed for proper use.

### INSTALLATION:

- A. After checking BB shell ① carefully, apply a thin layer of grease, PTFE (for Carbon) or anti-seize compound (for Ti) on the inside surface of BB shell ①.
- B. Apply a little bit of grease on the cup threads. DO NOT use PTFE, anti-seize or thread locking compound.
- C. First insert the drive side cup ③ preferable with a press tool, then insert non-drive side cup ② until the threads engage while making sure you do not cross-threads the cups.
- D. Use the BracketGrip cup tools to tighten until the lip of the cups are flush against the BB shell ① (Max. 40Nm, for Carbon shells lower torque is recommended).
- E. Add the Wave spring washer ⑥ on the Drive-side. If your BB shell ① is 89mm wide, add the 2.5mm spacer ④ as well.
- F. Install crankset following manufacturers specifications.

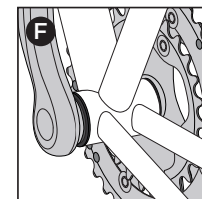
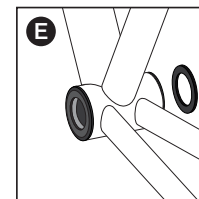
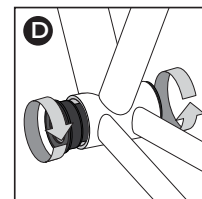
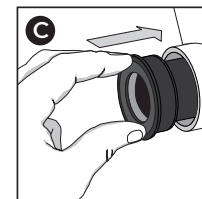
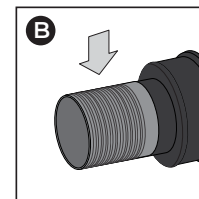
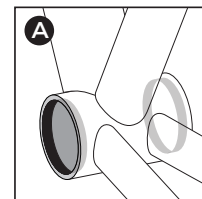

FIND YOUR TRANSLATION  
ON BBB CYCLING.COM



### WARNING

Sold only by professional bicycle dealers.  
For proper installation, ask your BBB dealer.  
Not following the instructions in this manual may cause damage to the product not covered under warranty, damage to the bicycle, or cause an accident resulting in injury or death.