



*HOW TO INSTALL YOUR FOCUS BIKE ON A*  
***SMART TRAINER***



*INSTALLATION*

# *SMART TRAINER*

|           |    |
|-----------|----|
| 1.1 TACX  | 03 |
| 1.2 WAHOO | 04 |

# Tacx

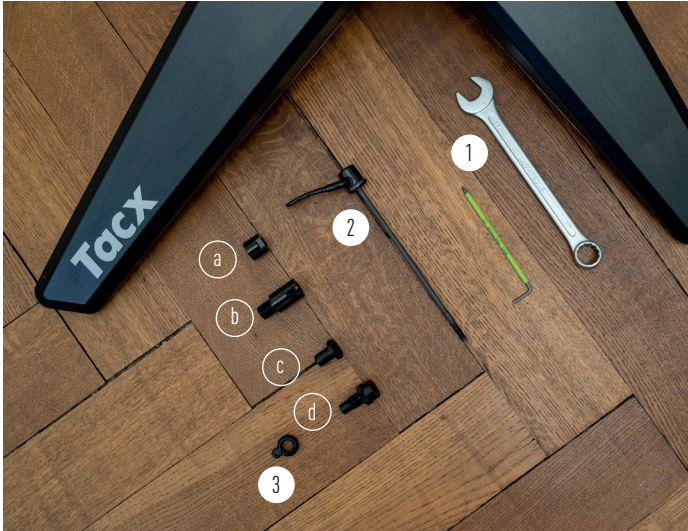

Tacx smart trainers use a quick release axle only. Due to the FOCUS R.A.T. axle, you have to exchange the R.A.T. Evo Insert on the right side of the dropout with a FOCUS threat thru-axle nut. You can order it through your local FOCUS dealer (article code: KD325919160).

## YOU JUST NEED THE FOLLOWING PARTS TO GET YOUR FOCUS BIKE ON A TACX TRAINER:

1. Tools: 15 mm wrench and a 2.5 mm Allen key.
2. TACX parts (like thru-axle and a, b, c, d) are most likely included in the delivery of the trainer.
3. Extra parts: FOCUS thru-axle nut, article code: KD325919160.



1. Take the R.A.T. Evo Insert off.



2. Assemble the FOCUS threat thru-axle nut (3).

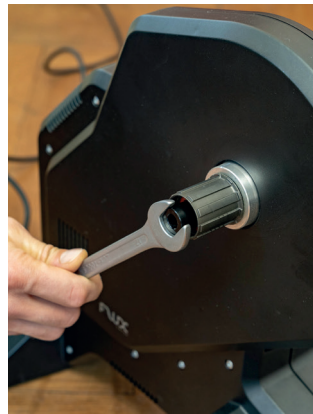

3. Tighten the spacer sleeve (2a) on the drive-side.



4. Tighten the spacer sleeve (2b) on the non-drive-side. Now your trainer is ready for the frame.



5. Stick in the sleeve (2c) on the non-drive-side through the dropout.

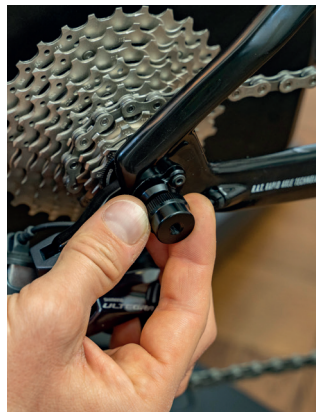

6. Screw the threat sleeve (2d) through the FOCUS threat thru-axle nut on the drive-side.



7. Tighten the TACX quick-release axle by hand until it is tight.



8. Do not fold the lever, just tighten the axle.





WAHOO smart trainers are working with all standard thru-axles. You can use your standard FOCUS R.A.T. thru-axle.

#### ALL YOU NEED TO GET YOUR FOCUS BIKE ON A WAHOO TRAINER:

1. WAHOO parts are included with your trainer.



1. Fit in the spacer sleeve (1a) on the drive-side.



2. Spacer sleeve (1b) is ready for two installation widths (142/148 mm).



3. Fit in the spacer sleeve (1b) on the non-drive-side. FOCUS road bikes are using 142 mm widths.



4. Use your FOCUS R.A.T. thru-axle.



5. If it's too hard to close the lever...

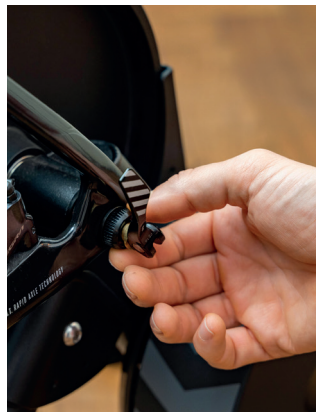

6. ...adjust the preload of the axle...



7. ...until the lever closes.



# *R I D E T O G E T H E R*

*R I D E B E Y O N D*

We hope we could help you. Should you still have any questions or feedback, you can contact us by email:  
[info@focus-bikes.com](mailto:info@focus-bikes.com)

Now it is time to sweat.  
Enjoy your indoor training.

Yours,  
FOCUS team